

81-89 Estcourt Road

Watford • Hertfordshire • WD17 2PY

PCM: £1,300 PCM



coopers
est 1986

This purpose-built, ground-floor one-bedroom maisonette is ideally situated in the sought-after Wilton Place on Estcourt Road, in the heart of Central Watford. Thoughtfully presented throughout, the property offers a spacious lounge and dining area, complemented by a modernised bathroom suite. Adding to its appeal, the apartment benefits from allocated parking as well as visitor parking bays for added convenience. Its prime location is a standout feature, being just 0.3 miles from Watford Junction Station and even closer to the vibrant Watford Town Centre, offering an excellent blend of comfort and accessibility.

Available IMMEDIATELY and offered unfurnished

Local authority: Watford Borough Council
Council tax: Band C

Ground floor maisonette

Close to Watford Station

Spacious living area

One bedroom

Stylish kitchen

Allocated parking and visitor parking

Modern bathroom

Walking distance to local amenities

Unfurnished

Available Immediately

Available Date

20th November 2024



GROUND FLOOR
517 sq.ft. (48.0 sq.m.) approx.

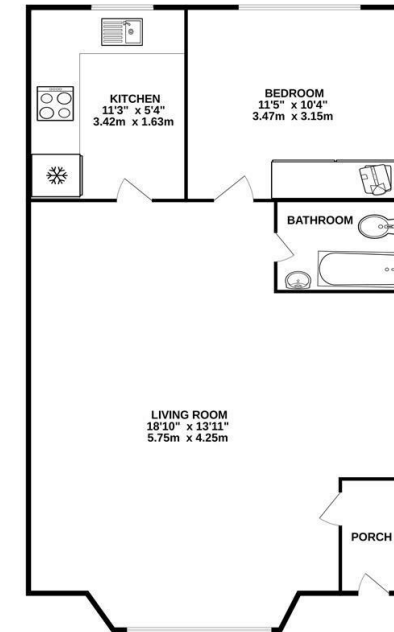

TOTAL FLOOR AREA: 517 sq.ft. (48.0 sq.m.) approx.
Whilst every attempt has been made to ensure the accuracy of the floorplan contained here, measurements of walls, windows, doors and any other items are approximate and no responsibility is taken for any error, omission or mis-statement. This plan is for illustrative purposes only and should be used as such by any prospective purchaser. The services, systems and appliances shown have not been tested and no guarantee is given for their condition or efficiency can be given.
Made with MapInfo CSD24



0208 017 6000

**18 Bridge Street, Pinner,
Middlesex, HA5 3JF**
pinner@coopersresidential.co.uk

CoopersResidential.co.uk

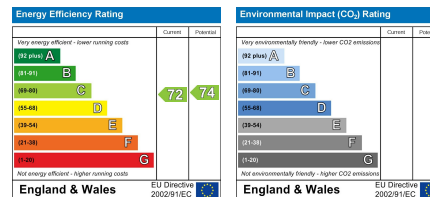

Important Notice: These particulars, whilst believed to be accurate are set out as a general outline only for guidance and do not constitute any part of an offer or contract. Intending purchasers should not rely on them as statements or representation of fact, but must satisfy themselves by inspection or otherwise has the authority to make or give any representation or warranty in respect of the property.

coopers
est 1986